

# IWCTT SERIES

## INDUSTRIAL WIRELESS CURRENT TRANSFORMER TRANSMITTER



### Typical Applications Include

- Simple cable replacement installation
  - dispense with expensive and tortuous cable runs
- Service Contract
  - temporary installation for servicing and field trials
- Rotating Machinery
  - Transmit signals to/from rotating machinery without slip rings etc.

## SPECIFICATIONS

### Transmitter Output

|                                |                                |
|--------------------------------|--------------------------------|
| <b>*Transmission Frequency</b> | 2.4 Ghz using ISM bands        |
| <b>Transmit Power</b>          | 18 dBm                         |
| <b>System Channel</b>          | User selectable via DIL switch |
| <b>Antenna</b>                 | Integral 0dBi                  |

\*Compliant with EN 300 328, V1.8.1

### Material Specifications

|                                    |  |
|------------------------------------|--|
| <b>Wireless Enclosure Material</b> | Plastic  |
| <b>Weight</b>                      | 150g including battery   |
| <b>*Installation position</b>      | Any  |
| <b>Environmental protection</b>    | Designed to IP68 (not recommended for submersion due to signal loss) |

\*Consult installation manual to ensure adequate signal path between transmitter and receiver

The IWCTT Wireless Transmitter is a cost effective alternative to traditional wiring that offers the advantages of a low-cost installation in inaccessible and expensive installation environments. Operates with any Split Core current transformer which gives a mV AC output, typically 333mV.

It is easily paired to any of the range of IWR receivers - thus offering a "plug and play" solution to your current measuring application.

The IWCTT sensor should be used with any of the IWR range of receivers. A line-of-sight range of up to 500 m is possible depending on the wireless receiver used (refer to specific receiver datasheets for further information).

### Features

- Operates with mV AC output current transformers
- Up to 500 m line-of-site range (depending on receiver)
- Five-year battery life at 10 second transmission update rate
- Simple DIL switch pairing with the single or five channel receiver
- User-selectable transmission update rates
- A range of receivers are available
- Receiver clean contacts provide process alarm functions

### Instrument Power Source

|                           |                                     |
|---------------------------|-------------------------------------|
| <b>Battery Type</b>       | User replaceable Lithium C cell     |
| <b>Battery Life</b>       | Five years at 10 second update rate |
| <b>Battery Shelf Life</b> | 10 years                            |

### Temperatures

|                                  |                |
|----------------------------------|----------------|
| <b>Ambient Temperature range</b> | -20°C to +50°C |
| <b>Storage Temperature</b>       | -20°C to +80°C |

## Input/Output Signals

|  |   |
|--|---|
| <b>Input (transmitter)</b>                   | mV AC from an AC current transformer  |
| <b>Receiver Part Number Receiver Outputs</b> |   |
| <b>IoT Gateway</b>                           | Built-in cellular modem allows all data to be sent to remote servers  |
| <b>IWR-PORT</b>                              | RS-232 or RS-485 or Ethernet MODBUS Communications. Up to 128 off analog 4-20 mA or Relay outputs can be obtained by fitting extra ISOSLICE I/O modules |
| <b>IWR-USB</b>                               | Displays & Logs data on any PC running IWR-USB software   |
| <b>IWR-5</b>                                 | 5 off 4-20 mA or 1-5 V dc and 1 Relay output  |
| <b>IWR-1</b>                                 | 1 off 4-20 mA and 1-5 V dc and 1 Relay output   |

## DIMENSIONS

All dimensions are in millimeters

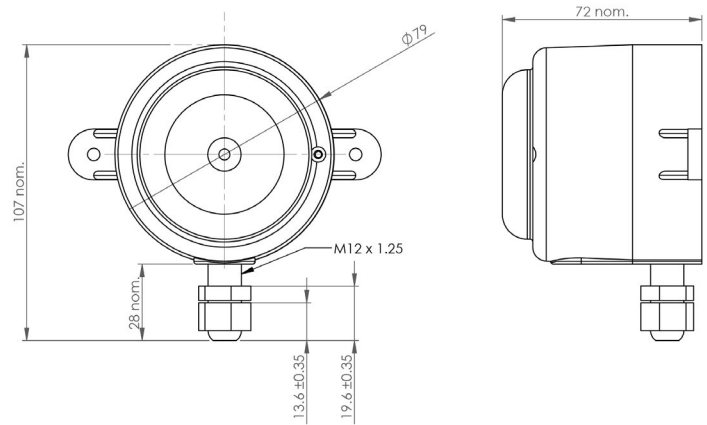

\*\*\*Transmission Update Rate 1, 5, 10 and 30 seconds

\*\*\* Consult installation manual for set-up:

- single channel system is DIL switch configurable
- five channel system requires set-up using "IWR Set" user software

## ORDERING OPTIONS

|  |  |
|--|--|
| <b>Wireless transmitter</b>                | IWCTT-00   |
| <b>Spare battery</b>                       | IBAT-1   |
| <b>Receivers</b>                           | See IoT Gateway, IWR-1, IWR-5, IWR-PORT and IWR-USB datasheets |
| <b>Five Channel Configuration Software</b> | IWR-Set (free download*)                                       |

Made in the UK

Page 2